



Fairlea Place, W5

LONG LET. This spacious one bedroom property is set in an ideal location on a quiet residential street in the heart of Ealing.

- COMMUNAL GARDENS
- CLOSE TO TRANSPORT
- SEPARATE KITCHEN
- STYLISH BATHROOM
- GREAT LOCATION
- LARGE BEDROOM

£1,550 PCM

Fairlea Place

Approximate Gross Internal Area
506 sq ft - 47 sq m

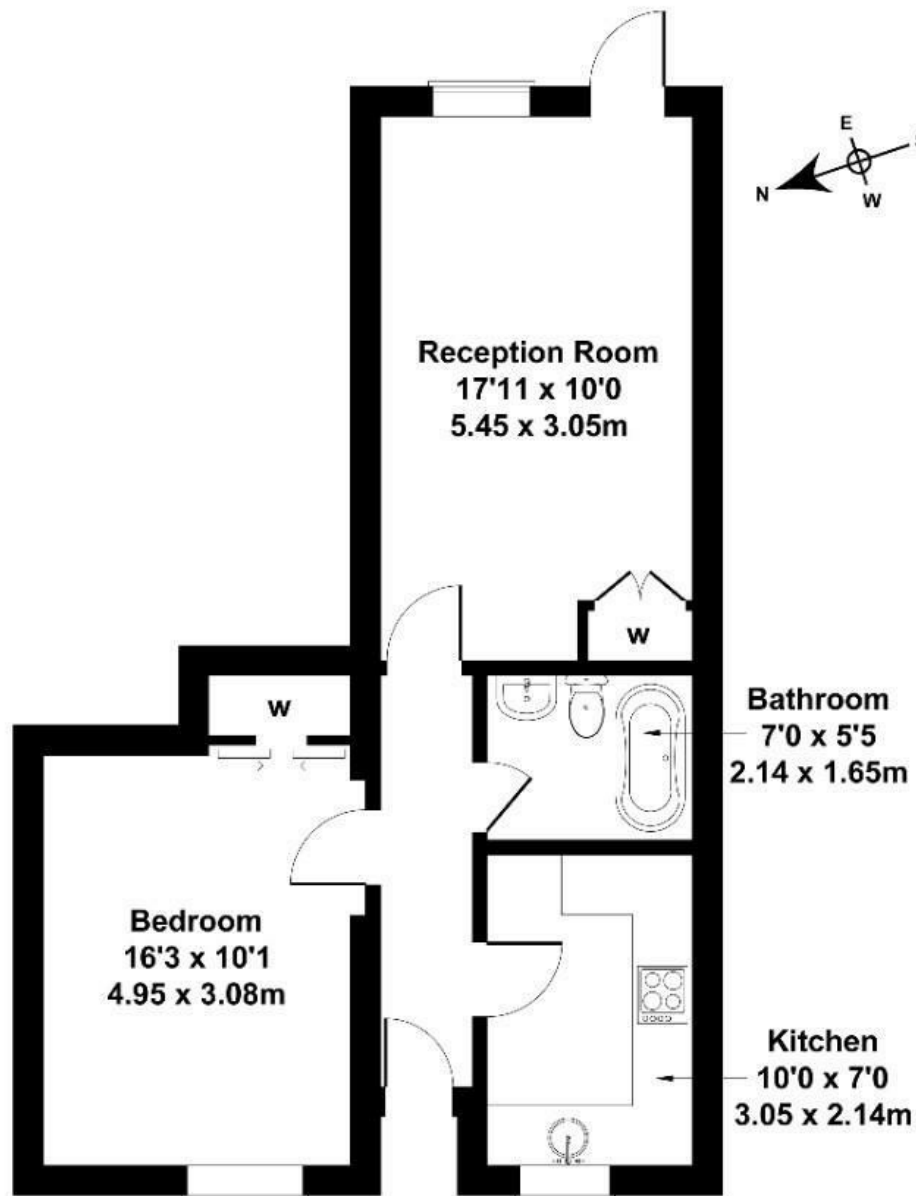

GROUND FLOOR

Not to Scale. Produced by The Plan Portal 2025
For Illustrative Purposes Only.

Energy Efficiency Rating		
	Current	Potential
Very energy efficient - lower running costs		
(92 plus) A		
(81-91) B		
(69-80) C		
(55-68) D		
(39-54) E		
(21-38) F		
(1-20) G		
Not energy efficient - higher running costs		
England & Wales	EU Directive 2002/91/EC	